

Manifold Flange Connections

**NO THREADS.
NO SWEAT.**

MANIFOLD FLANGE
CONNECTORS



Smart. The quick-change connection allows you to replace or inspect fittings in seconds as opposed to time consuming threaded liquid handling systems.

Easy to Use. There is no pipe thread installation, no chance of cross threading, no pipe sealant and no cure time needed.

Versatile. By nature of the connection – it is easier to redesign, alleviate space constraints and add pieces to your liquid handling system.

Universal. Replaces fittings made with either traditional National Pipe Thread (NPT) or British Standard Pipe Thread (BSP) connections. So no matter what part of the world you live in, you too can use Banjo Manifold Connections.

Breadth. Banjo Manifold Connections are available in Electric Valves, 3-Way Valves, Bolted Ball Valves, Stubby Valves, Dry-Disconnects, Flow Meters, Sweeps, Line Strainers, Hose Barbs, Couplings, Fittings, Swivels, Tank Fittings and Pumps.



Original System



Updated System



MANIFOLD FLANGE CONNECTIONS

1" Banjo Electric Manifold Valve Assemblies

2 Valve Manifold



3 Valve Manifold



3 VALVE MANIFOLD ASSEMBLY (M200 SERIES)
W/ MOUNTING BRACKETS

FLANGED MOUNTING BRACKET TEE

4 Valve Manifold



5 Valve Manifold



1" Micro Electric Manifold Valve

FEATURES

- 12 Volt DC
- Stationary current draw: less than 0.04 amps.
- Rotating current draw: less than 0.40 amps.
- Stall current: 0.75 amps
- Response time: 1/3 sec open to close
- TFM seats
- EPDM seals
- Fiberglass reinforced polypropylene ball.
- Integrated mounting slot
- Standard 3 wire configuration.
- Max Pressure = 200 PSI @ 70 °F.

MANIFOLD FLANGE CONNECTIONS



1/3 Second Response Time

1" MICRO ON/OFF ELECTRIC MANIFOLD VALVE						
PART NO	DESCRIPTION	MAX PSI	PIPE SIZE	OPENING THRU BALL	QTY	PRICE
MLEV100	1" Micro Electric Manifold Valve	200	1"	1/2"	1	\$196.10

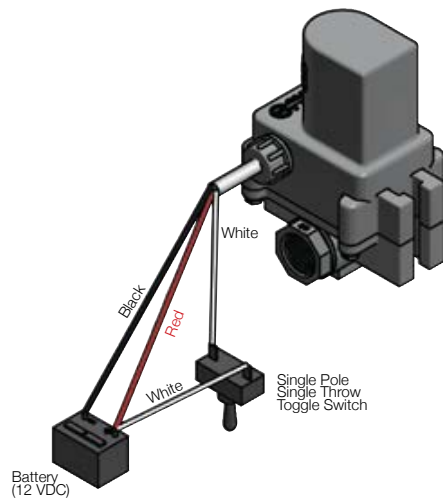

MANIFOLD FLANGE CONNECTIONS



MANIFOLD FLANGE CONNECTIONS

MLEV100

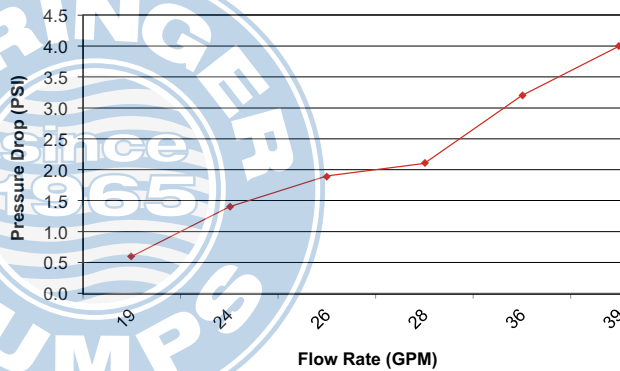

1"-2" Electric Manifold Valves

FEATURES

- 1"-2" has 316 stainless steel ball & stem.
- Fiberglass reinforced polypropylene.
- Glass reinforced PTFE seats.
- FKM (viton type) or EPDM O-rings.
- 12-volt DC operated.
- 150 P.S.I. maximum pressure.
- Internally fused/automatic reset.
- Open/closed indicator.

MANIFOLD FLANGE CONNECTIONS



Note: 2 wire regulating and other response times available. Contact our Sales Team for part number and availability of valves.

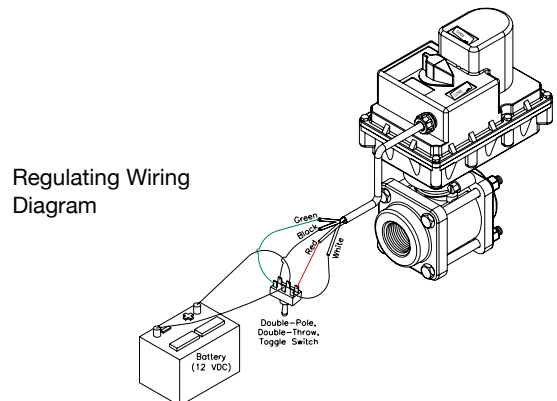
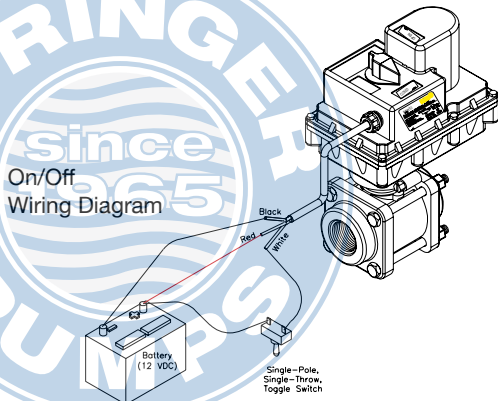

3" Electric Manifold Valves

FEATURES

- 3" has poly ball & stainless steel stem.
- Fiberglass reinforced polypropylene.
- Glass reinforced PTFE seats.
- FKM (viton type) or EPDM O-rings.
- 12-volt DC operated.
- 150 P.S.I. maximum pressure.
- Internally fused/automatic reset.
- Open/closed indicator.

MANIFOLD FLANGE CONNECTIONS

Don't forget the manifold connections on pages 81-85.



Note: 2 wire regulating and other response times available. Contact our Sales Team for part number and availability of valves.

On/Off
Wiring Diagram

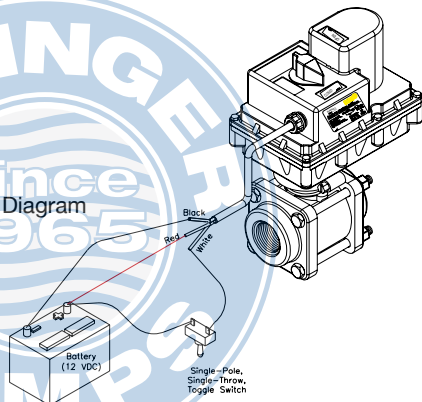

3-Way Side Load Electric Manifold Valves 1", 1½", & 2" Full Port

FEATURES

- 316 stainless steel ball & stem.
- Fiberglass reinforced polypropylene.
- Glass reinforced PTFE seats.
- FKM (viton type) or EPDM O-rings.
- 12-volt DC operated.
- 150 P.S.I. maximum pressure.
- Internally fused/automatic reset.
- Open/closed indicator.

MANIFOLD FLANGE CONNECTIONS



SIDE LOAD:
Directional flow left or right. Valve flow cannot be turned off.

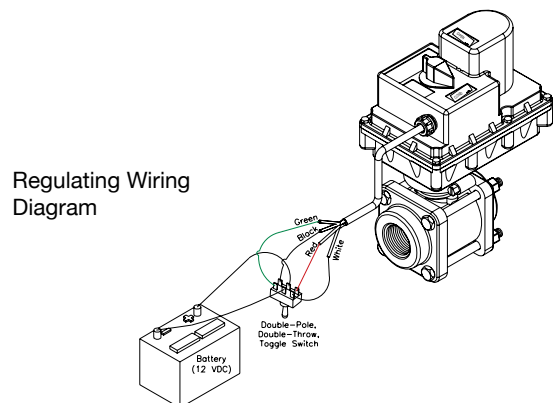
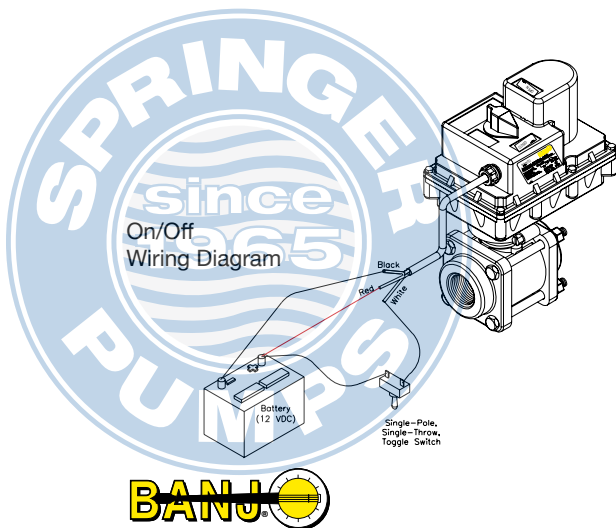

3-Way Bottom Load Electric Manifold Valves 1", 1½", & 2" Full Port

FEATURES

- 316 stainless steel ball & stem.
- Fiberglass reinforced polypropylene.
- Glass reinforced PTFE seats.
- FKM (viton type) or EPDM O-rings.
- 12-volt DC operated.
- 150 P.S.I. maximum pressure.
- Internally fused/automatic reset.
- Open/closed indicator.

MANIFOLD FLANGE CONNECTORS

On/Off
Wiring Diagram

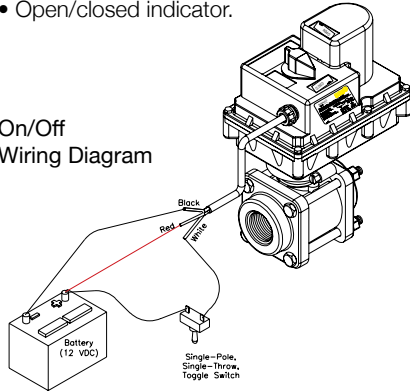

NOTE: NO Regulating Valve available for 3-way bottom load electric manifold valves.

Manifold Pressure Spike Valves

FEATURES

- Precision molded in polypropylene. Polypropylene is reinforced with fiberglass for additional strength.
- Preset pressure spring.
- Poppet is diamond turned, after molding, to make it spherically perfect, which provides precise seal.
- 360° Orientation.
- FKM (viton type) seals.

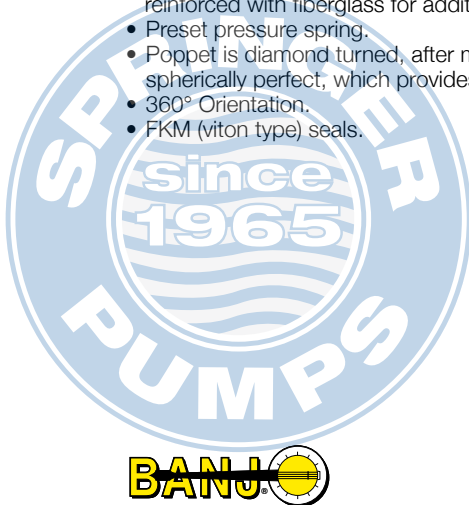

Manifold Bolted Ball Valves 4 and 6 Bolt Valves

FEATURES

- FKM (viton type) seals.
- PTFE self-lubricating stem bushings and seats cannot stick or bind.
- Precision molded in polypropylene. Polypropylene is reinforced with fiberglass for additional strength.
- Self-aligning ball moves freely against the PTFE seats for smooth operation. The valve opens and closes with very little pressure on the handle.
- Ball is diamond turned, after molding, to make it spherically perfect, which provides precise contact between ball and seats.

MANIFOLD FLANGE CONNECTIONS



*Valve repair kits contain items marked with asterisk
 1 Ball 2 Body O-Rings 1 Thrust Washer
 2 Ball Seats 1 Upper Stem Bushing 1 Stem O-Ring

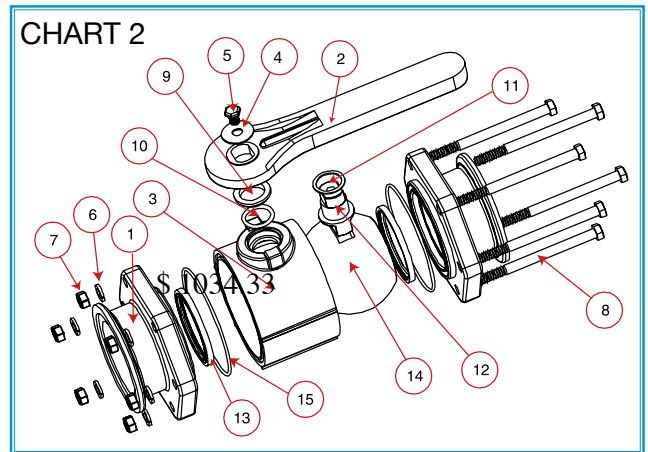
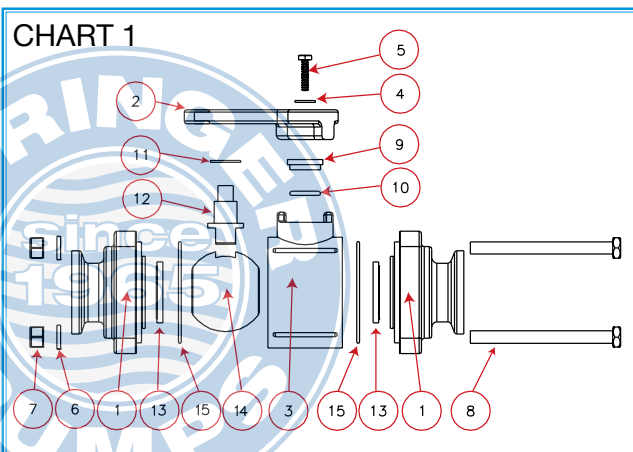

Manifold Bolted 5 Way Ball Valve

FEATURES

- FKM (viton type) seals.
- PTFE self-lubricating stem bushings and seats cannot stick or bind.
- Precision molded in polypropylene. Polypropylene is reinforced with fiberglass for additional strength.
- Self-aligning ball moves freely against the PTFE seats for smooth operation. The valve opens and closes with very little pressure on the handle.
- Ball is diamond turned, after molding, to make it spherically perfect, which provides precise contact between ball and seats.

MANIFOLD FLANGE
CONNECTORS



Manifold Valves

2" Standard Port Manifold "Stubby" Valve

PATENTED™

FEATURES

- Stainless steel bolts.
- Glass reinforced polypropylene.
- Multiple design options.
- Unique patented compact design.
- Lightweight.
- Maximum operating pressure 100 P.S.I. @ 70°F. 75 P.S.I. @ 150°F.

MANIFOLD FLANGE
CONNECTORS



VSMT200CF



VSF200CF

Manifold Valves

2" Full Port Manifold "Stubby" Valve

PATENTED™



MVS220FP



MVS220CF



MVSF220FP



MVSMT220FP



Manifold Valves

2" Full Port Stainless Steel Manifold "Stubby" Valve

PATENTED

FEATURES

- Stainless steel bolts.
- Glass reinforced polypropylene.
- Multiple design options.
- Unique patented compact design.
- Lightweight.
- Maximum operating pressure 100 P.S.I. @ 70°F. 75 P.S.I. @ 150°F.

MANIFOLD FLANGE CONNECTIONS



MVS220HSFP



MVSF220HSFP



MVSMT220HSFP

FEATURES

- 100% PTFE ball seats.
- Unique compact design.
- All TFE seals. No elastomers.
- 1000 P.S.I. maximum



MVSF220SS



Manifold Valves

3" Manifold "Stubby" Valve

PATENTED™

FEATURES

- Stainless steel bolts.
- Glass reinforced polypropylene.
- Multiple design options.
- Unique patented compact design.
- Lightweight.
- Maximum operating pressure 100 P.S.I. @ 70°F. 75 P.S.I. @ 150°F.

MANIFOLD FLANGE
CONNECTIONS



MVSF300



MVSF300FP



MVSMT300



MVS300CF



MVS300CFFP



Manifold Valves

3" Full Port Stainless Steel Manifold "Stubby" Valve

PATENTED

FEATURES

- Stainless steel bolts.
- Glass reinforced polypropylene.
- Multiple design options.
- Unique patented compact design.
- Lightweight.
- Maximum operating pressure 100 P.S.I. @ 70°F. 75 P.S.I. @ 150°F.

MANIFOLD FLANGE
CONNECTORS



MVS300HSFP



MVSF300HSFP



MVSMT300HSFP



3-Way Manifold Ball Valves

FEATURES

- Stainless steel bolts.
- Precision molded in polypropylene. Polypropylene is reinforced with fiberglass for additional strength.
- Self-aligning ball moves freely against the PTFE seats for smooth operation.
- The valve opens and closes with very little pressure on the handle.
- Ball is diamond turned, after molding, to make it spherically perfect, which provides precise contact between ball and seats.
- PTFE self-lubricating stem bushings and seats cannot stick or bind.
- Maximum operating pressure 100 P.S.I.
- FKM (viton type) seals.

MANIFOLD FLANGE CONNECTIONS



MV100BL



MV200BL



MV220BL

BOTTOM LOAD: Directional flow right or left. Valve can be turned off to stop flow.



3" 3-WAY

MV300BL

BOTTOM LOAD: Directional flow right or left. Valve can be turned off to stop flow.

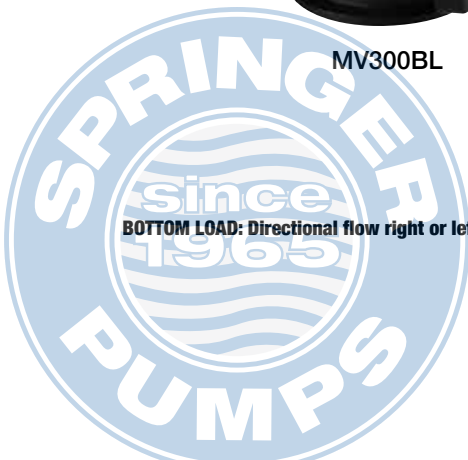

3-Way Manifold Ball Valves

FEATURES

- Stainless steel bolts.
- Precision molded in polypropylene. Polypropylene is reinforced with fiberglass for additional strength.
- Self-aligning ball moves freely against the PTFE seats for smooth operation.
- The valve opens and closes with very little pressure on the handle.
- Ball is diamond turned, after molding, to make it spherically perfect, which provides precise contact between ball and seats.
- PTFE self-lubricating stem bushings and seats cannot stick or bind.
- Maximum operating pressure 100 P.S.I.
- FKM (viton type) seals.

MANIFOLD FLANGE
CONNECTIONS



MV100SL



MV200SL



MV220SL



MVT220SL

SIDE LOAD: Directional flow right or left. Valve cannot be turned off.

* Non-Stock Item



Manifold Dry Disconnect

FEATURES

- Lightweight.
- Unrestricted flow.
- Minimal fluid spillage.
- Easy to use.
- Economical.
- Reduces risk of exposure.
- Wide range of chemical resistance.
- Cannot be uncoupled in open position.
- Handles cannot be opened after male and female are separated.
- 100 P.S.I. maximum operating pressure.



MALE

FEMALE

Note: Male & female sold separately. Replacement parts for 2" manifold Dry-Mate on page 95.

MANIFOLD FLANGE CONNECTIONS

Polypropylene Inductors

FEATURES

- Threaded or manifold ends.
- Glass reinforced polypropylene.
- 1½" & 2" sizes available.

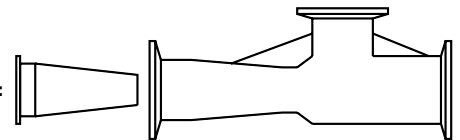

Each venturi comes in two pieces:



MHV200
MHV220A

HV150
HV200

NOTE: The inductor is designed for use with a volume pump. Typical volumes and pressures used to operate the venturi would be in the 80 to 240 US GPM range at pressures from 26 to 52 P.S.I.

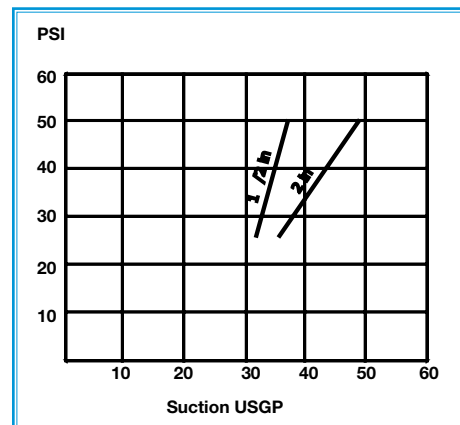

*Note: US GPM. Tests done with water at ambient temperature. Pump used for test was a 2" Banjo (5 vane impeller) driven by a 5.5 hp Honda gas motor. Performance may vary depending on pump used & product being pumped.

MANIFOLD FLANGE CONNECTIONS

Manifold Inductor System

FEATURES

- Installed after pump; suction completely empties inductor tank.
- Keeps tank free of chemicals.
- 2" & 3" full port flow.
- Easy assembly/installation with manifold connections.

*Note: Tank not included.

Draws wettable powders or liquids from inductor tank for thorough chemical mixing!



Flanged fittings, clamps & gaskets on page 85.

